

# Bluetooth USB Adapter, Parani™ SD1000U



## Features

- Bluetooth Specification v2.0 + EDR Class 1
- Working distance (In an open field): Normally 300 meters, up to 600m using 5 dipole antenna
- USB 2.0 interface
- Supports Windows, Linux, Mac OS and Windows CE.NET operating systems.
- No Bluetooth driver required.  
(No Toshiba or BlueSoleil driver required.)
- Provides transparent RS232 serial cable replacement for PC
- Supports Bluetooth Serial Port Profile (SPP)
- Supports up to 4 multiple simultaneous connections
- Interoperability with laptops, PDA terminals etc.
- Easy to use Windows configuration tool available.

**The Parani-SD1000U** is a class 1 type Bluetooth USB adapter for Serial Port Replacement that supports 300 meters of wireless transmission distance by default. The working distance can be further extended up to 600 meters using 5 dipole antenna can be replaceable.

It is suitable for industrial and special applications because it can cover longer communication distance (1000m) over other regular Bluetooth USB adapter accessories.

## Exterior

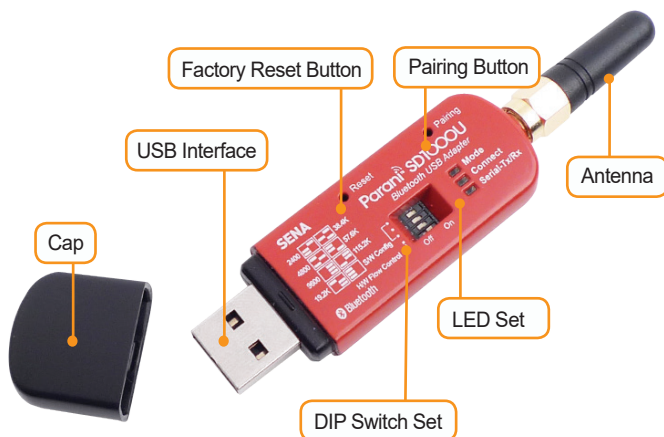

**SENA**

## Specifications

### Standards

- Bluetooth 2.0+EDR Class 1
- USB 2.0

### Max Transfer Rate

- 3 Mbps (EDR)

### Frequency Range

- 2.402 ~ 2.480GHz

### Transmit Output Power

- +18dBm

### Receive Sensitivity

- Basic 1Mbps: -90dBm
- EDR 2Mbps: -88dBm
- EDR 3Mbps: -87dBm

### Diagnostic LED

- Mode
- Connect
- Serial-Rx/Tx

### Antenna Connector

- RP-SMA

### Antenna Gain

- Default Stub Antenna: 1 dBi
- Optional Dipole Antennas: 3 dBi & 5 dBi

### Working Distance (In Open Field)

Stub Antenna	- Stub Antenna	300 meters
Dipole Antenna (3 dBi)	- Dipole Antenna (3 dBi)	400 meters
Dipole Antenna (5 dBi)	- Dipole Antenna (5 dBi)	600 meters

### Driver Software

- FTDI(FT232R) USB-Serial driver in public domain (<http://www.ftdichip.com/Drivers/VCP.htm>)
- No Toshiba or BlueSoleil driver required.

### Supported Bluetooth Profiles

- Serial Port Profile (SPP)

### Computer OS Support

- Windows 7
- Windows 7 x64
- Windows Server 2008
- Windows Server 2008 x64
- Windows Vista
- Windows Vista x64
- Windows Server 2003
- Windows Server 2003 x64
- Windows XP
- Windows XP x64
- Windows 2000
- Windows ME
- Windows 98
- Linux
- Mac OS X
- Mac OS 9
- Mac OS 8
- Windows CE.NET (Version 4.2 and greater)

### Environmental

- Operating Temperature: -40°C ~ +85°C
- Storage Temperature: -40°C ~ +85°C
- Humidity: 90% Non-condensing

### Physical properties

- Dimension (L x W x H)
  - 68 mm x 22 mm x 11.5mm (2.6 in x 0.8 in x 0.4 in) without cap
  - 71 mm x 22 mm x 11.5mm (2.7 in x 0.8 in x 0.4 in) with cap
  - 97 mm x 22 mm x 11.5mm (3.8 in x 0.8 in x 0.4 in) with cap&1dBi stub
- Weight: 56 g

### Regulatory Approvals

- FCC, CE, TELEC, KC, IC, Bluetooth SIG

### Warranty

- 1 year limited warranty

## Ordering Information

### SD1000U-G01 Includes

- Parani-SD1000U
- Stub antenna
- Quick Start Guide
- CD-ROM including Driver, User guide and Data sheet

### Optional Accessories

- SAT-G01R: 1 dBi Stub Antenna - RP-SMA Plug Right-hand Thread
- DAT-G01R: 3 dBi Dipole Antenna - RP-SMA Plug Right-hand Thread
- DAT5-G01R: 5 dBi Dipole Antenna - RP-SMA Plug Right-hand Thread
- SEC-G01R: 15cm Extension Cable (For SAT-G01R / DAT-G01R / DAT5-G01R)

For more information,  
please visit us at <http://www.senanetworks.com>

**SENA**